

# ROAD & FIRE SYSTEM PLANS

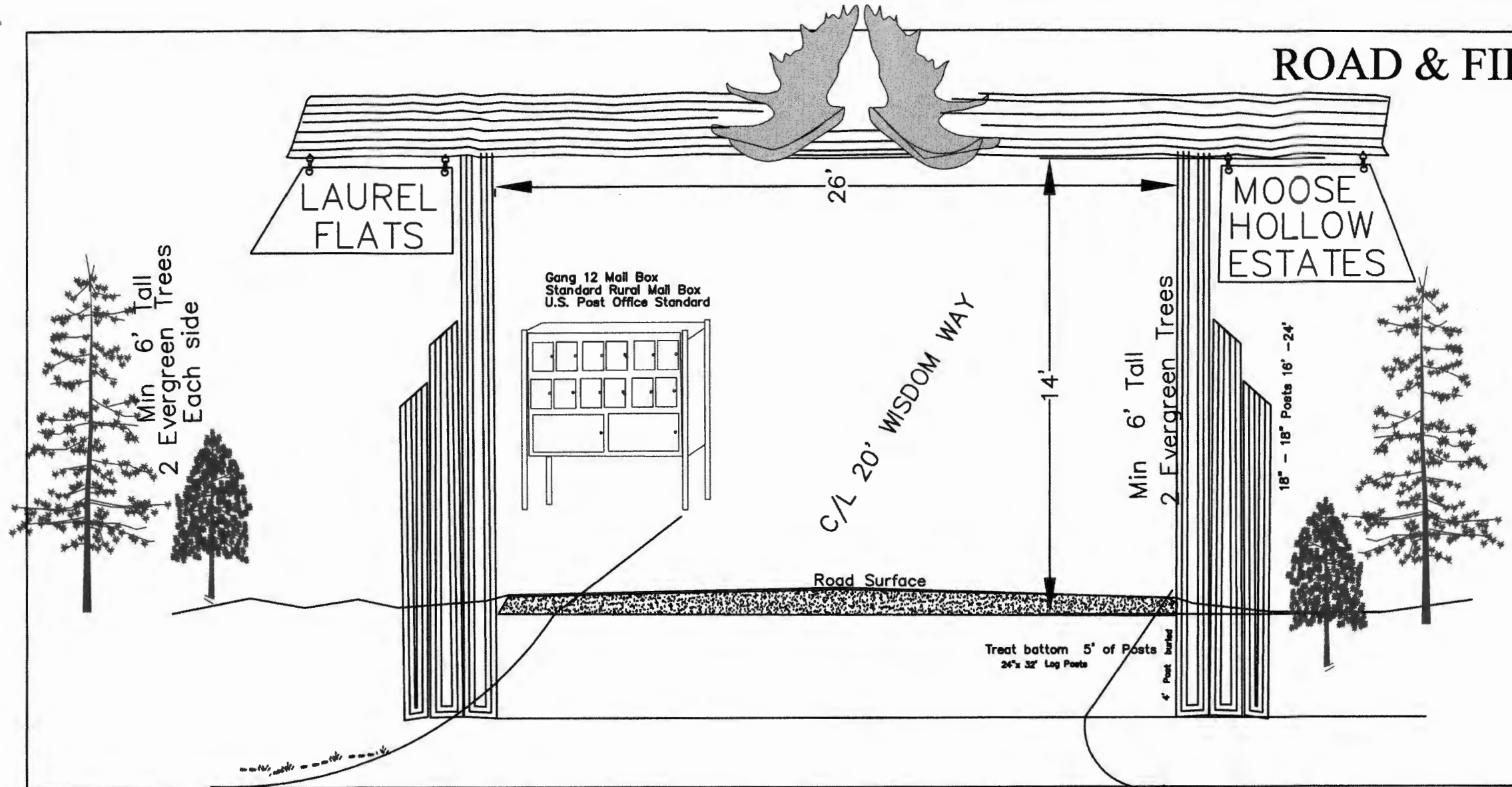

Plans Legend	
●	Lot Corner
—	Lot Property Line
- - -	Section Line
- · - · -	Irrigation Line
- - - - -	Road Edge Line
- · - · - · -	Set Back Perimeter
—	10" PVC Water Pipe
~ ~ ~	Topo lines
- · - · - · -	Utility Easement
▨	Fire Truck Turn Out
▩	Co. Road R.O.W
⬠	Exist Structure

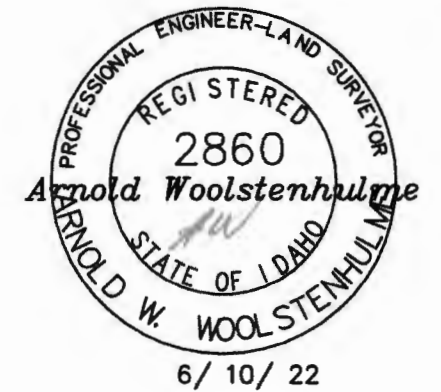

## Landscape & Entrance Sign

C/L Co Road W 1000 S

### Project Specifications & Notes

CONTRACTOR TO NOTIFY ADJACENT PROPERTY OWNERS AND DIG LINE 48 HOURS BEFORE DIGGING.  
 THE SPECIFICATIONS FOR THIS PROJECT ARE TETON COUNTY & THE IDAHO STANDARDS FOR PUBLIC WORKS CONSTRUCTION (current edition).  
 ALL WORK WILL MEET TETON COUNTY STANDARDS & REQUIREMENTS.  
 IT IS THE CONTRACTOR'S RESPONSIBILITY TO OBTAIN PERMITS AND FOLLOW ALL COUNTY REGULATIONS.  
 THE ROAD SYSTEM IS TO BE MAINTAINED BY THE DRAKE CREEK RESERVE H.O.A.  
 ALL IRRIGATION WATER LINES WILL BE PRIVATELY OWNED AND MAINTAINED BY THE H.O.A.  
 NOTIFY THE PROJECT ENGINEER BEFORE WORK IS COVERUP OR YOU PROCEED TO NEXT PHASE OF WORK.  
 ROAD WORK WILL HAVE TO BE APPROVED BY COUNTY ENGINEER BEFORE ACCEPTED.  
 FIRE POND AND SYSTEM WILL HAVE TO BE APPROVED BY THE FIRE DEPARTMENT BEFORE ACCEPTED.

### PROJECT QUANTITIES

1- ROAD SUBEXCAVATION 22' wide	900 Cu Yds
2- ROADWAY -PIT RUN GRAVEL 12"	1320 Cu Yds
3- 20' ROAD 4" of 3/4" CRUSHED GRAVEL	420 Cu Yds
4- 18" X CULVERT METAL PIPE (CMP)	40 L.F.
5- ENTRANCE, GATE, MAIL BOX ETC	SUM
6- 4" PVC IRRIG TRUNKLINE BURIED	600 Lin Ft
8- DRY FIRE HYDRANT	1 Each
9- WATER VALVES 4"	3 Each
10- WELL, PUMP ETC	SUM
11- WATER -1.5" BURIED SERVICE LINE	100 Lin Ft
12- TIE INTO IRRIGATION SYSTEM 9+00	2 EACH
13- ENTRANCE LANDSCAPE	1 SUM

### INDEX

INDEX	PAGE
Title Page	R-1
Road Plan & Profile	R-2
Road Cross Section	R-3
Erosion Control Typicals	R-4
Fire Pond Layout	F-1
Fire Pond Details	F-2
Fire Pond Wel & Fill	F-3
Irrig Layout Laurel Flats	Irrg-1
Irrig Layout Moose Hollow	Irrg-2
Irrig System Details	Irrg-3

Road Plan & Profile

Owner: Kelly Lark  
 7856 Hidden Valley Rd  
 Marahing, Id 83639

Proj # 22-05  
 Page: Rd 1 of 4

**AW** ENGINEERING  
 255 SOUTH MAIN P.O. BOX 139  
 VICTOR, IDAHO 83485  
 (208) 787-2852 aweng@ida.net

2-13-23 D



6/10/22

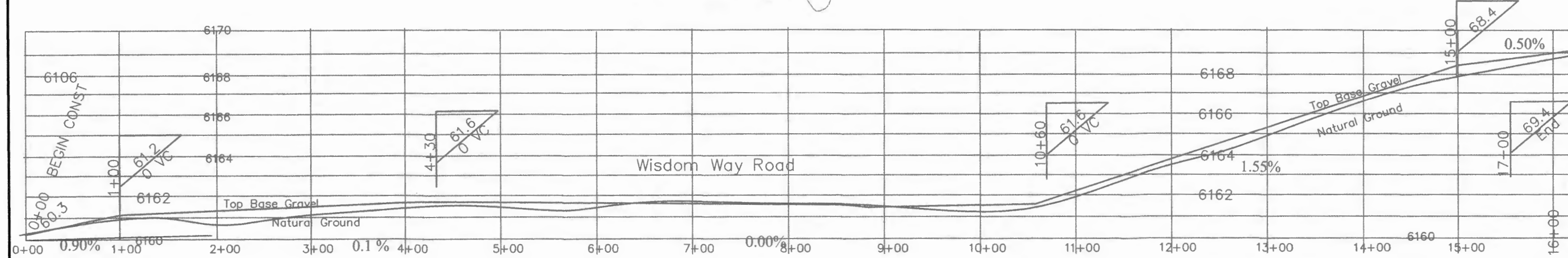
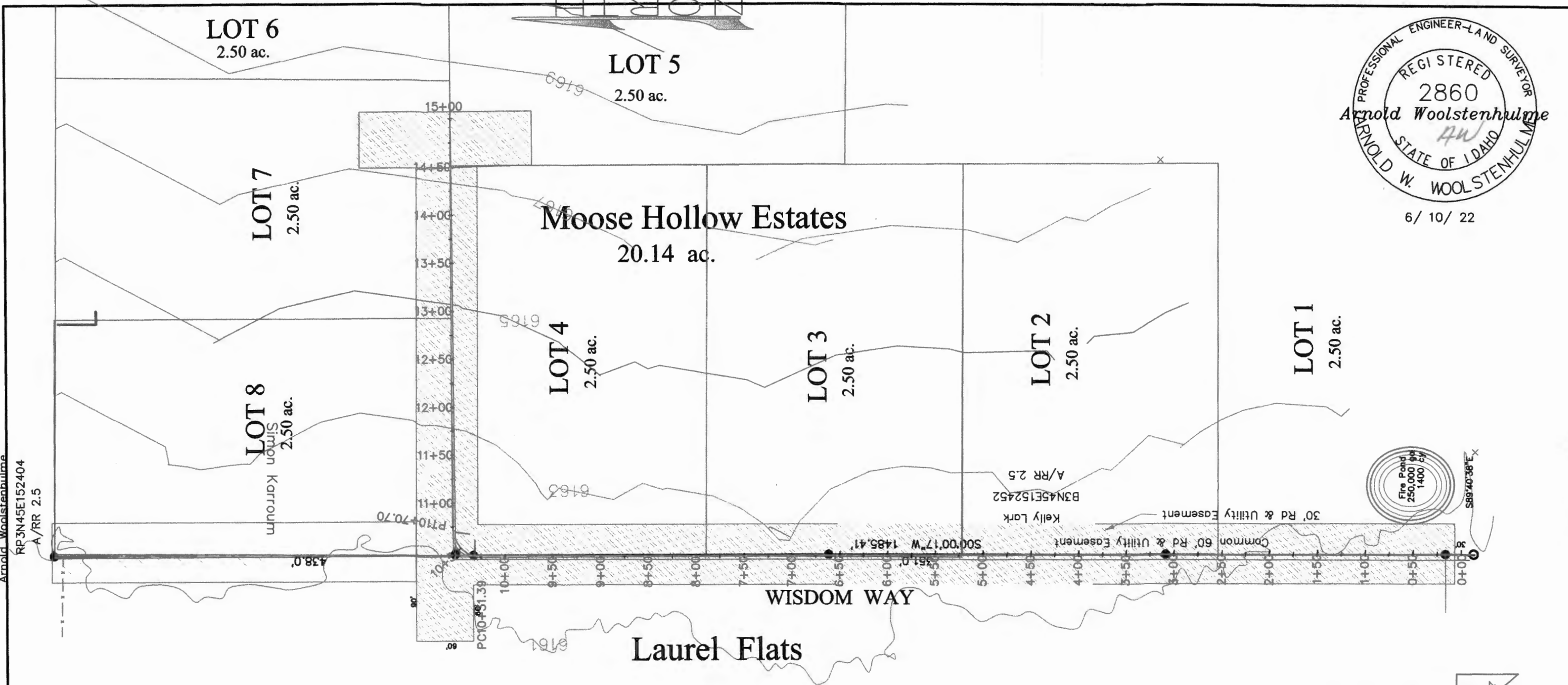

8/10 /22

Road Plan & Profile

Owner: Kelly Lark  
7856 Hidden Valley Rd  
Marshing, Id 83639

Proj # 22-05  
Page: Rd 2 of 4



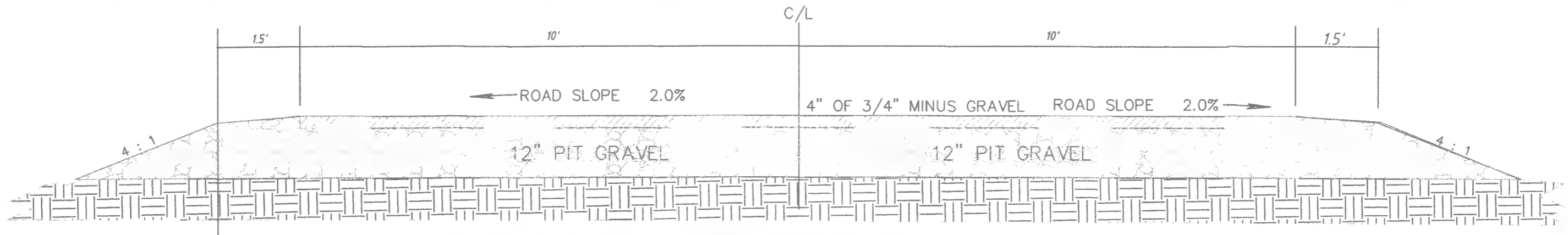

( NOT TO SCALE )

### TYPICAL ROAD TEMPLATE & CROSS SECTION

FOR ROADS IN TETON COUNTY, IDAHO.

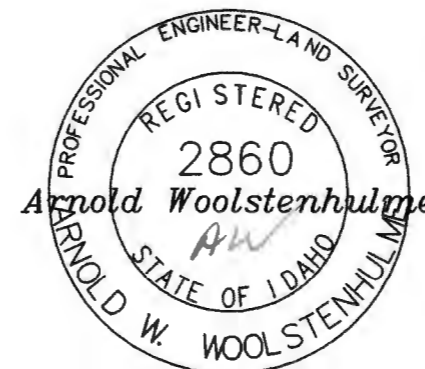
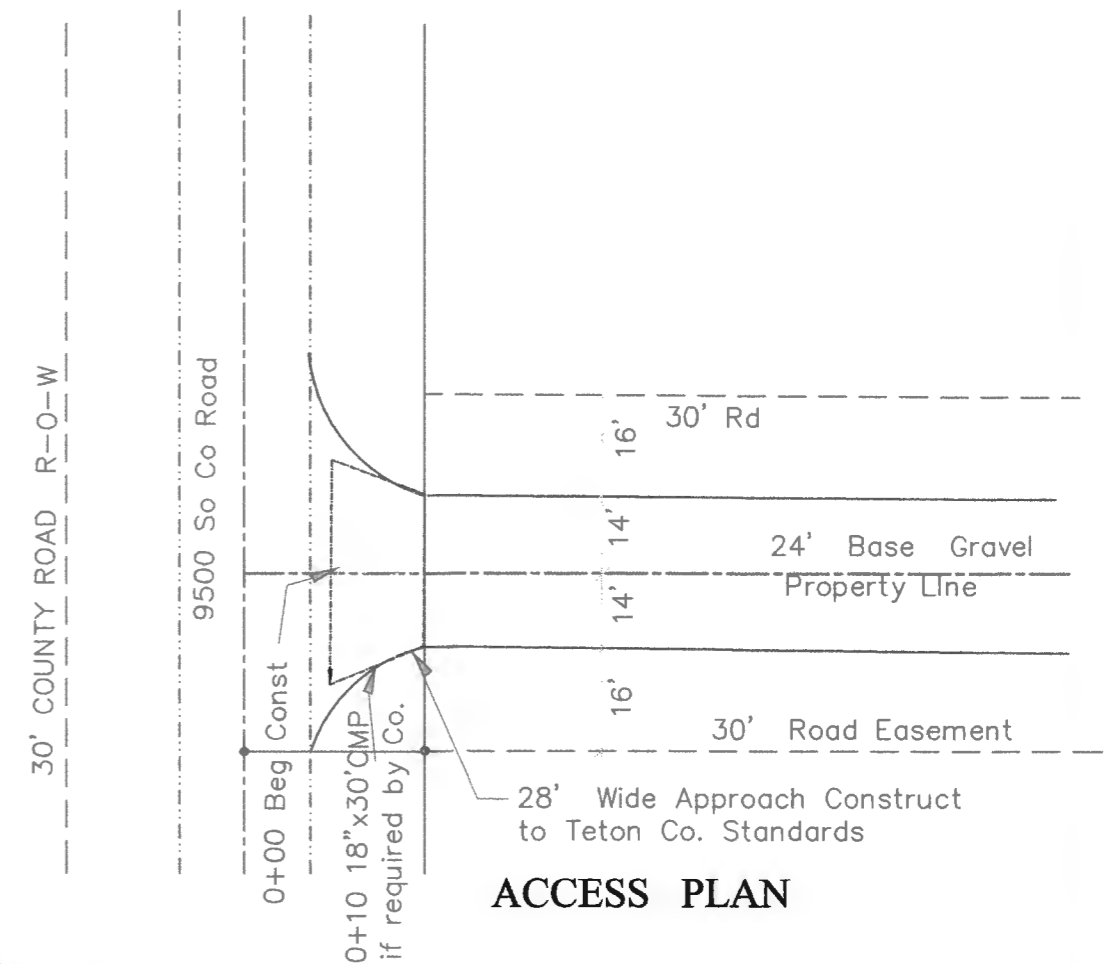
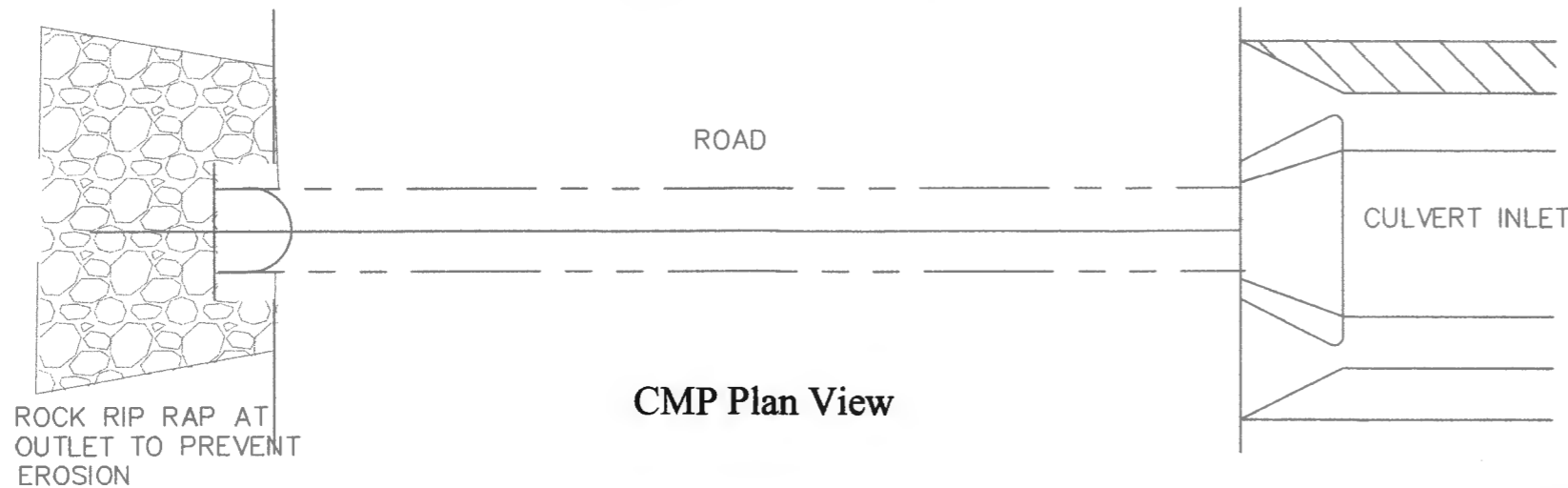
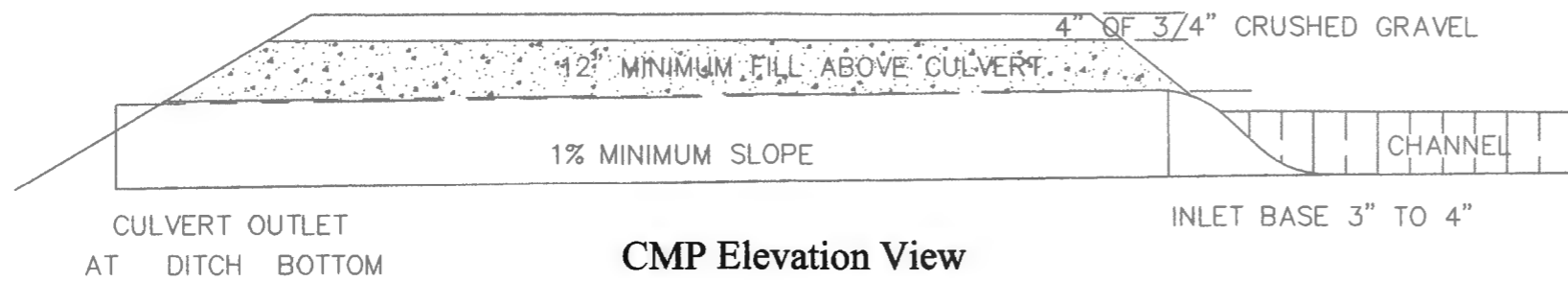

6/10/22

Sign Details  
 posts to be 4" x 4" x 8 ft minimum  
 bury posts minimum of 30" deep  
 sign to be 2' high by 3' wide minimum  
 lettering to be minimum of 3" high

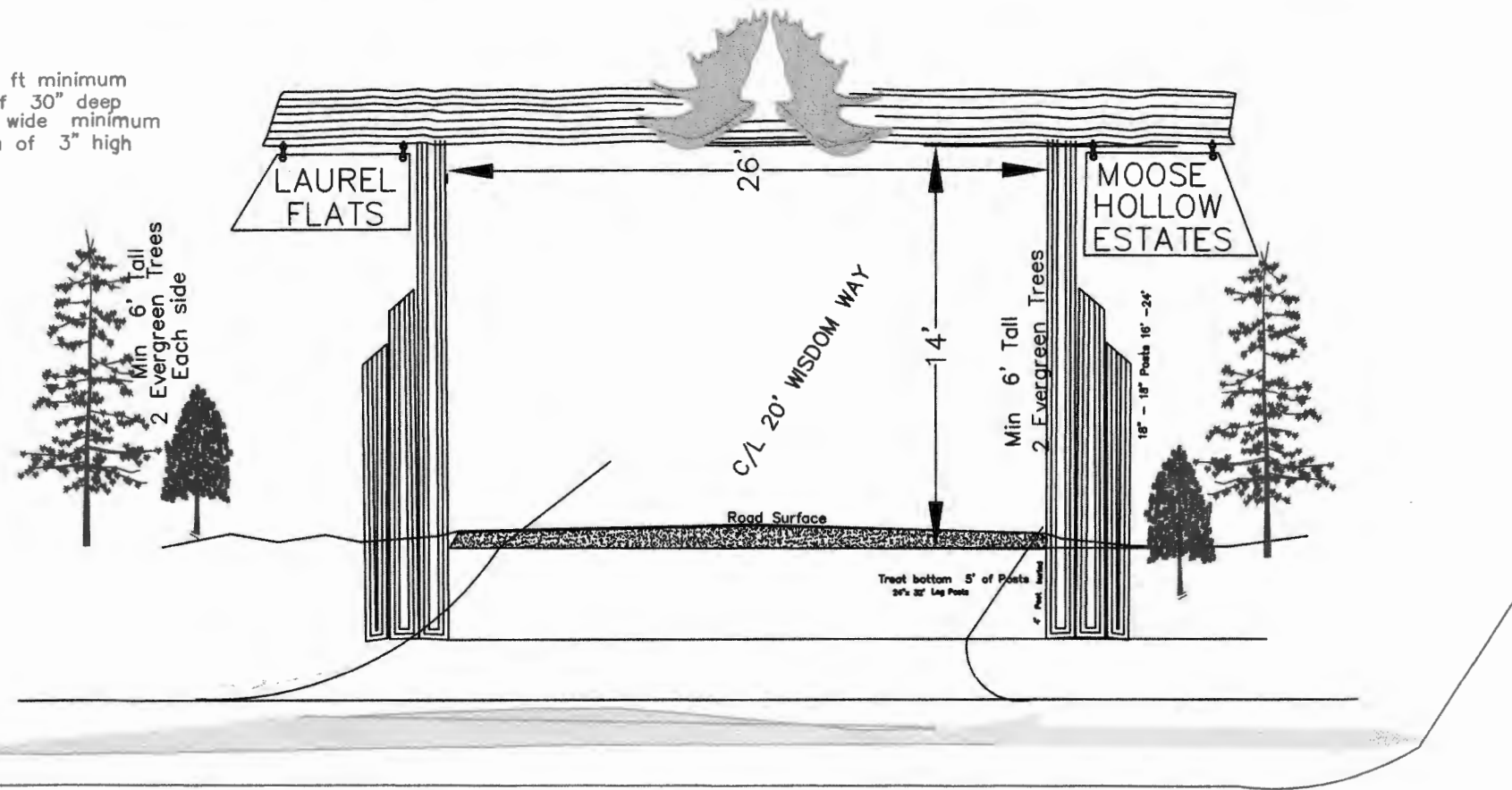

Gang Mail Box  
 Standard rural mail boxes  
 u.s. post office standards

ENTRANCE SIGN AND LANDSCAPING

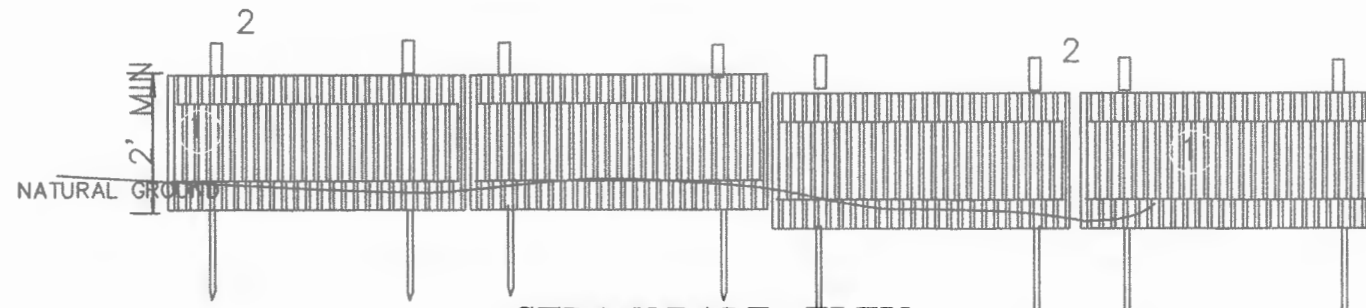

STRAW BALE - ELEV

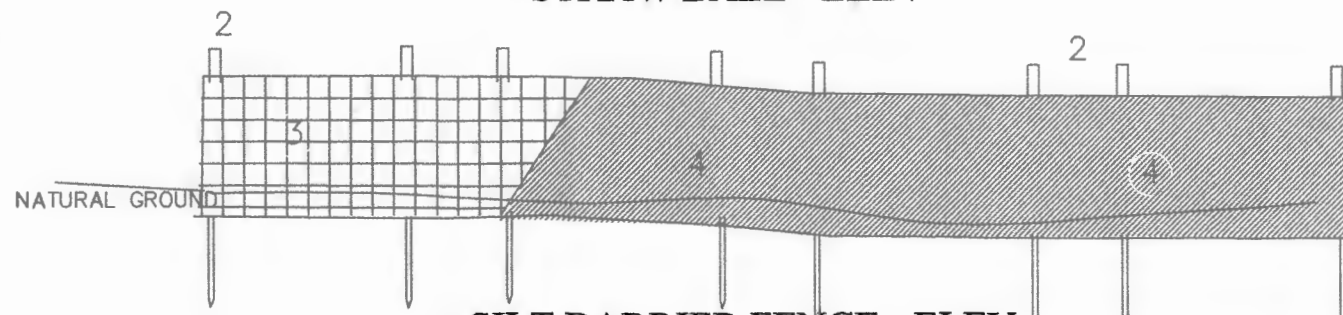

SILT BARRIER FENCE - ELEV

### EROSION CONTROL MEASURES

THE FOLLOWING BMP'S WILL BE UTILIZED ON THIS PROJECT IN THE AREAS AS REQUIRED AND NEEDED TO PREVENT EROSION AND POLLUTION RUNOFF AND POLLUTION ONTO NEIGHBORING PROPERTIES AND THE ENVIRONMENT.

- BMP # 25 SILT FENCING  
 A STANDARD 2 FEET HIGH SILT FENCE WILL BE ESTABLISHED ALONG THE SOUTH WEST AND SOUTH PROPERTY LINE ALONG THE POND.  
 THIS FENCE WILL BE INSTALLED AND MAINTAINED FOR ONE YEAR AFTER CONSTRUCTION WORK IS DONE.
- BMP # 21 INLET PROTECTION  
 PIPE INLETS WILL BE PROTECTED WITH A FIBER BUNDLE AROUND THE INLET PERIMETER OF THE PIPE. PLACE FIBER BUNDLE FOR 10 FEET AROUND INLET.
- BMP # 22 OUTLET PROTECTION  
 PIPE OUTLET AREAS WILL BE PROTECTED FROM EROSION WITH 1 Cu Yd OF ROCK RIP RAP PLACE AROUND THE PIPE OUTLET.
- BMP # 6 DUST CONTROL DURING CONSTRUCTION  
 WHEN THE SITE IS DRY AND DUSTY FROM SITE DUSTURBANCES THE FOLLOWING CONTROL MEASURES WILL BE TAKEN DURING CONSTRUCTION WORK:  
 1 - STAGING OF WORK AND LIMITING EXPOSED SOIL AREAS AND WHEN POSSIBLE, MAINTAIN VEGETATIVE GROUND COVER, RESEED OR STABILIZE EXPOSED TOPSOIL AREAS.  
 2 - SPRINKLE DISTURBED AREAS WITH WATER ON TEMPORARY ROAD AREAS WHERE TRUCKS ARE CROSSING SOIL AREAS.  
 3 - ESTABLISH WND BARRIERS FENCING UPWIND OF DISTURBED AREAS.
- BMP # 9 VEHICLE / EQUIPMENT MAINTENANCE  
 A DESIGNATED VEHICLE STORAGE AND MAINTENANCE YARD WILL BE CREATED. THIS AREA WILL BE GRADED AND BERMED. ANY WASTE WATER WILL BE COLLECTED INTO A POND. POLLUTANTS SUCH AS OIL, GREASE, FUELS, ETC. WILL BE COLLECTED IN A LINED POND.

